

# WIRE HOOK

TEST  
METHOD 4

STAINLESS  
304  
STEEL

TF

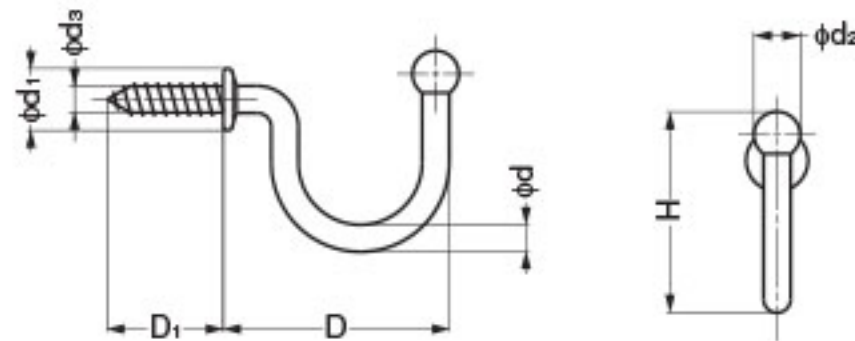
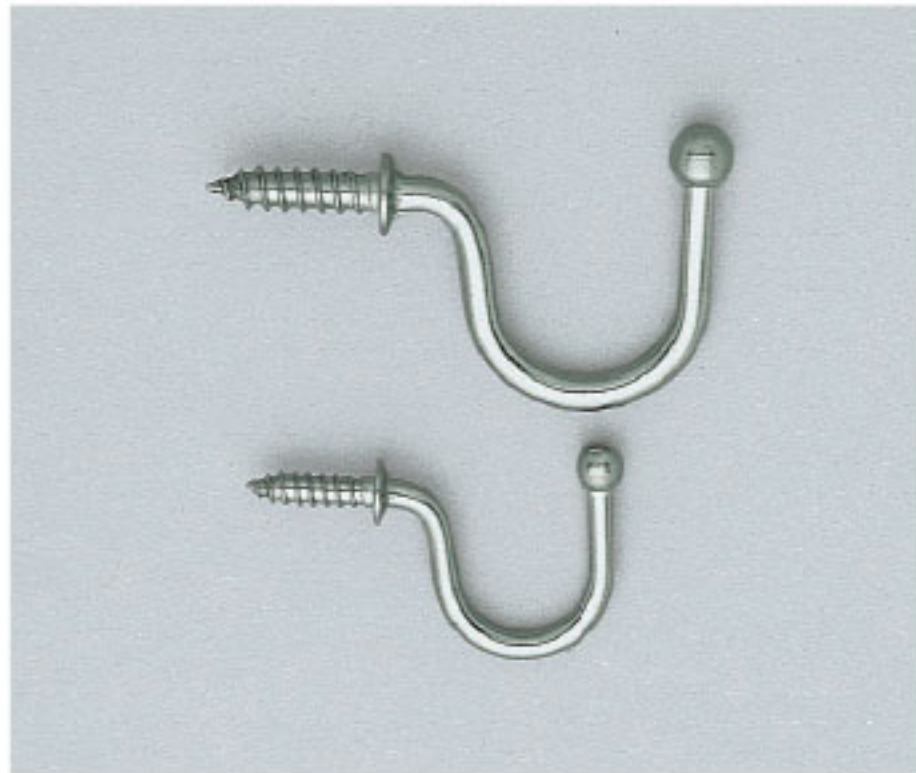

## Features

- Hook has ball end, making it safer to use and preventing detachment.

Item Code	Item Name	Material	Finish	D	D <sub>1</sub>	H	d	d <sub>1</sub>	d <sub>2</sub>	d <sub>3</sub>	Load Capacity	Weight	Box	Carton
110-020-055	TF-20	Stainless Steel (SUS304)	Polished	20.8	11	20	2.7	6.5	4.5	3.3	29.4 N	3 g	200 pcs	7200 pcs
110-020-056	TF-30	Stainless Steel (SUS304)	Polished	29.2	15	26	3.5	8	6	4.2	68.6 N	5.5 g	100 pcs	1800 pcs
110-020-057	TF-35	Stainless Steel (SUS304)	Polished	40.5	20	35	4.5	10	7.5	5.4	117.6 N	13.5 g	50 pcs	900 pcs